

S45 AUTOMATE 2.0Nm | 28mm

The motorized 28mm 2.0Nm S45 roller shade system offers multiple tubes to suit a variety of applications. Featuring ARC (Automate Radio Communication), the 28mm 2.0Nm S45 system provides an intelligent Li-ion battery powered solution.

AESTHETICAL FEATURES

- Thinner Motor Head
- Recessed mounting hooks

PRODUCTION & ASSEMBLY FEATURES

- Smaller Motor end deduction
- Greater flexibility during installation with spring loaded pin end
- Crown, drive and adapters available to suit variety of tube sizes

FUNCTIONAL BENEFITS

- 5V Micro USB Charging
- Antennae Wire Retention Feature
- Levelling control
- Simple limit setting and adjustment
- Favorite position
- 3 operational speed settings
- ARC protocol for simple programming
- 2-WAY RF communication

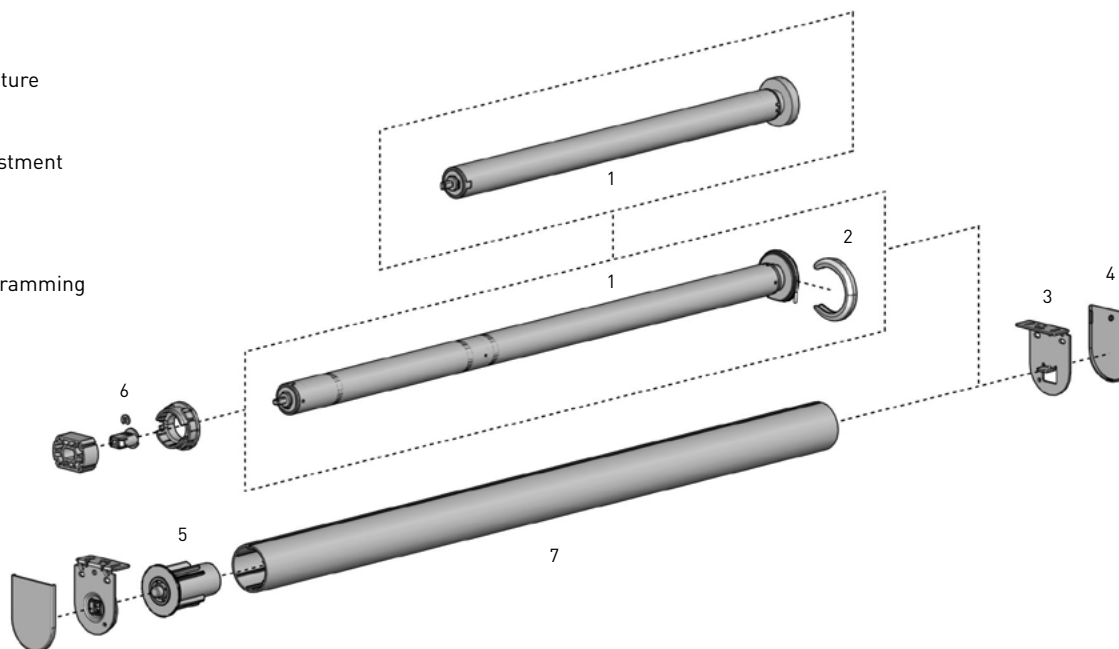

SYSTEM INDEX

1	Automate Motor 28mm MT01-1328-069001 - Li-ion 2.0 ZERO MTDCRFQ28-2 - DCRF 2.0
2	Motor Cap MT03-0205-xxx001
3	Brackets RB09-0352-xxx0XX
4	Bracket Covers RB08-4152-xxx0XX
5	Pin End RB0-0245-xxx001
6	Crown & Drive Set 28mm DC MTCRDR-28-S45
7	T-Spline Aluminum Tubes RB93-044#-000490 RB93-644#-000490

- Size
xxx= Color
X = catalogue options

COLOUR RANGE



SYSTEM UPGRADES

- CF90 CASSETTE
- CF90 EDGE
- LINK SYSTEM

CONTROL OPTIONS

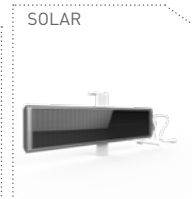

PRODUCT OPTIONS



SPECIFICATIONS

SYSTEM CAPACITY

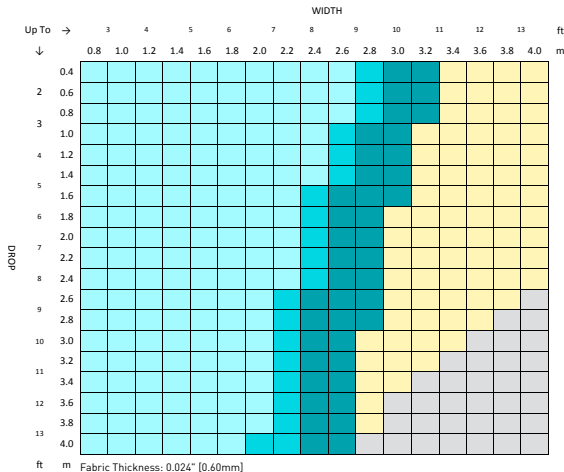

Fabric Thickness: 0.024" [0.60mm]
 Fabric Density: 12.39oz/yd² [420gsm]
 Weight Bar: D30 Silent Medium Aluminium Bottom Rail

CONTROL	TUBE	LINK SYSTEM
25mm Motor	S45 LIGHT	1.5" ONLY
	S45 STANDARD	
	S45 HEAVY DUTY	
	OUTSIDE SPECIFICATIONS	

DEDUCTION CHART

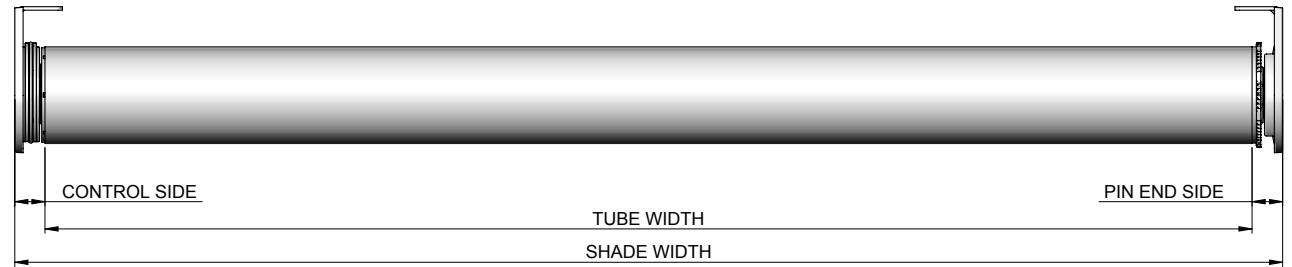

MOTOR	TORQUE	BRACKETS	LIGHT GAP			MINIMUM SHADE WIDTH
			CONTROL END	PIN END	OVERALL	
MT01-1328-069002*	2.0Nm	With Covers	0.59" [15mm]	0.55" [14mm]	1.14" [29mm]	2.49' [0.760m]
		No Covers	0.51" [13mm]	0.51" [13mm]	1.02" [26mm]	
MTDCRF28-2		With Covers	0.60" [15mm]	0.55" [14mm]	1.14" [29mm]	2.00' [0.600m]
		No Covers	0.55" [14mm]	0.51" [13mm]	1.06" [27mm]	

* MOTOR IS SUITABLE FOR RETROFIT INSTALLATION IN EXISTING RB09, RB08 & RB07 SYSTEMS. EXTEND THE MKII IDLER 2MM FOR RB08 & RB07 RETROFIT INSTALLATIONS.

TUBE DEDUCTION = BLIND WIDTH - (CONTROL END LIGHT GAP + PIN END LIGHT GAP)

MAX ROLL

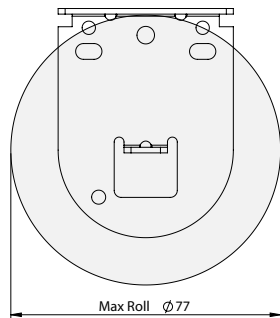

BRACKET	MAX ROLL SIZE
RB09-0352-xxx040	3.03" [77mm]
RB09-0352-xxx055	4.21" [107mm]

TUBE SPECS.

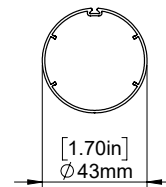

S45 Light Tube
 Code RB93-0443-000490
 w. tape RB93-6443-000490
 Length 16' [4.88m]

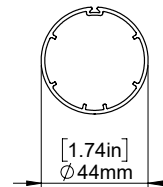

S45 STD Tube
 Code RB93-0444-000490
 w. tape RB93-6444-000490
 Length 16' [4.88m]

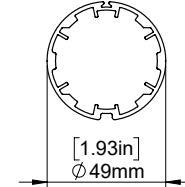

S45 HD Tube
 Code RB93-0449-000490
 w. tape RB93-6449-000490
 Length 16' [4.88m]

MAX LIFTING CAPACITY				MAX DROP**
MOTOR	S45 LT	S45 STD	S45 HD	S45
1.1Nm	11.46lbs [5.2kg]	11.24lbs [5.1kg]	10.14lbs [4.6kg]	13.12' [4.0m]

** Exceeding this value may cause fabric tracking issues