

## MOTOR PROGRAMMING INSTRUCTIONS

# 5V Wand Motor

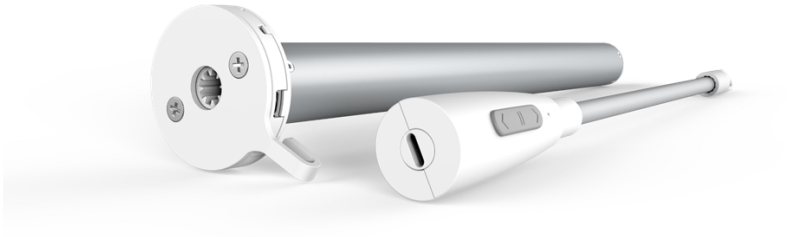

BATTERY  
POWERED



ELECTRONIC  
LIMIT



SELECTABLE  
SPEED



FAVORITE  
POSITION



USB CHARGE

---

AUTOMATE™ | Wand Motor & Wand Control offers a wire-free, rechargeable, easy to program and use solution to suit a large range of applications.

The favorite position feature allows a pre-set position to be recalled for precise alignment at a desired mid window position.

### FEATURES:

---

- Lithium-ion battery powered
- Electronic Limits
- Selectable Speed
- Favorite Position
- USB Charge
- Child Safe Wand Control available in White in 36" length:

# CONTENTS

<b>1</b>	<b>ASSEMBLY</b>	<b>4</b>
<b>2</b>	<b>OPERATION NOTE</b>	<b>5</b>
<b>3</b>	<b>BUTTON DESCRIPTION</b>	<b>5</b>
<b>4</b>	<b>INITIAL SETTINGS</b>	<b>6</b>
4.1	Factory Settings	6
4.2	Change Motor Direction of Rotation	6
4.3	Set Limits	7
<b>5</b>	<b>ADJUSTING SET LIMITS</b>	<b>8</b>
5.1	Adjust Upper Limit	8
5.2	Adjust Lower Limit	9
<b>6</b>	<b>FAVORITE POSITION</b>	<b>10</b>
6.1	Setting a Favorite Position	10
6.2	Send Shade to Favorite Position	10
<b>7</b>	<b>STEPPING MODE</b>	<b>11</b>
7.1	Enter Stepping Mode	11
7.2	Exit Stepping Mode	11
<b>7</b>	<b>STEPPING MODE</b>	<b>12</b>
8.1	Increase Motor Speed	12
8.2	Decrease Motor Speed	12
<b>9</b>	<b>RESTORE FACTORY SETTINGS</b>	<b>12</b>
<b>10</b>	<b>TROUBLE SHOOTING</b>	<b>13</b>

# SAFETY INSTRUCTIONS

## WARNING: Important safety instructions to be read before installation.

Incorrect installation can lead to serious injury and will void manufacturer's liability and warranty.

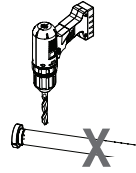
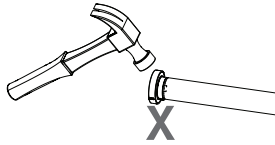

## CAUTION

- Do not expose motor to moisture or extreme temperatures.
- Do not allow children to play with this device.
- Modification of motor in any shape or form will void warranty.
- Use or motor for other than intended use as outlined in this manual will void warranty.
- For use within tubular blinds.
- Ensure correct crown and drive adapters are used for the intended system.
- Keep antenna straight and clear from metal objects
- Do not cut the antenna.
- Use only Rollease Acmeda hardware.
- Ensure torque and operating time is compatible with system weight.
- Do not expose or immerse motor in water or install in humid or damp environments.
- Motor only to be installed horizontally.
- Do not drill into motor body.
- The routing of cable through walls shall be protected by isolating bushes or grommets.
- Ensure power cable and antenna is clear and protected from moving parts.
- Do not operate if cable or power connector is damaged.

## Important safety instructions to be read prior to operation.

- It is important for the safety of persons to follow the enclosed instructions. Save these instructions for future reference.
- Persons (including children) with reduced mental capacity, or lack of experience and knowledge should not be allowed to use this product.
- Keep remote controls away from children.
- Frequently inspect for improper operation. Do not use if repair or adjustment is necessary.
- Keep motor away from acid and alkali.
- Do not force the motor drive.
- Keep clear when in operation.



Li-ion



Do not dispose of in general waste.  
Please recycle batteries and damaged electrical products appropriately.



# 1 ASSEMBLY

Please refer to Rollease Acmeda System Assembly Manual for full assembly instructions relevant to the hardware system being used.

**Step 1.** Cut roller tube to required length.

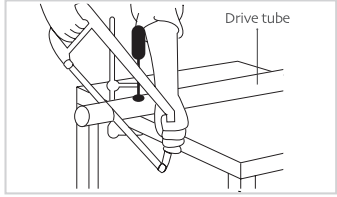

**Step 2.** Ensure roller tube is clean and free from burrs.

**Step 3.** Fit required crown, drive and bracket adapters.

Tube must be close fitting with chosen crown and drive adapters. Refer to Rollease Acmeda System Assembly Manual for recommended crown, drive, and bracket adapter kits.

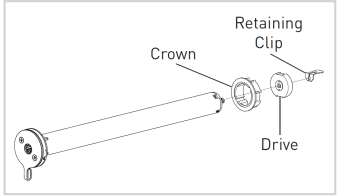

**Step 4.** Slide Motor into tube.

Insert by aligning keyway in crown and drive wheel to the tube.

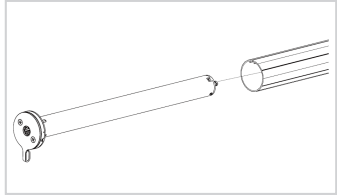

**Step 5a.** R-Series Installation:

Mount motorized tube onto brackets.

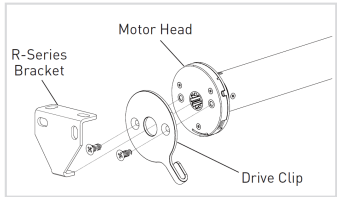

**Step 5b.** Skyline Installation

Assemble with Motor with Slam Adapter

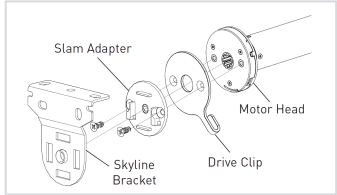

**Step 6.** Attach the Wand to the Motor.

Ensure power connector is attached to motor head.

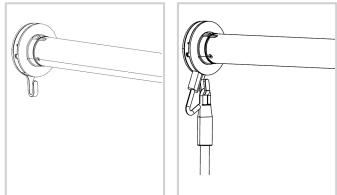

## 2 OPERATION NOTE

This motor has a 12V built-in Li-ion battery pack with integrated charge management.

- Before first use ensure that motor is fully charged.
- Don't operate the motor on low voltage ie. if the LED in the Wand is flashing.
- Set the limit positions before use to avoid damaging the motor or shade.
- The motor will stop if something blocks free movement of the shade.
- The motor will enter "sleep" mode to save battery life if the control wand is not operated within 6 minutes.

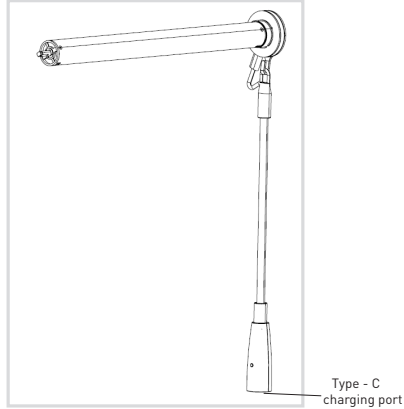

### IMPORTANT

Ensure antenna and wand connector cable are kept clear of fabric.

## 3 BUTTON DESCRIPTION

MANUAL KEY:

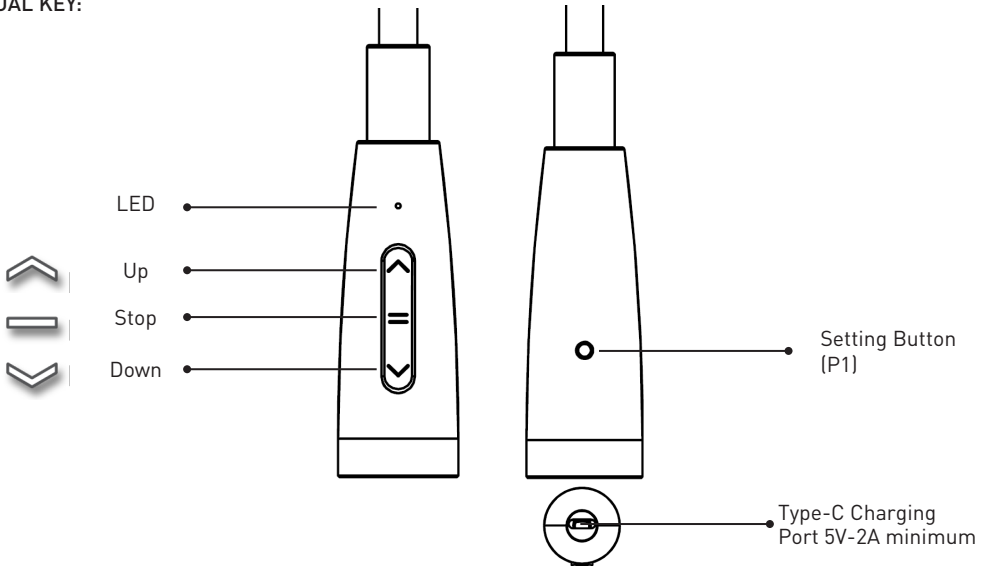

## 4 INITIAL SETTINGS

### 4.1 Factory Settings

To check travel direction of shade, press **UP** or **DOWN** on controller.

Press **UP**  
button



OR

Press **DOWN**  
button



OR

Press **STOP** button  
to stop motor



**QUICK PRESS** = Step



**LONG PRESS** = Continuous Travel



#### **IMPORTANT**

Damage to shade may occur when operating motor prior to setting limits. Attention should be given.

### 4.2 Change Motor Direction of Rotation

OPTION 1: To reverse shade direction, press and hold the STOP Button for 2 seconds

Press & Hold  
**STOP** Button



Motor Response

APPROX.



JOG  
X 1

OPTION 2 (Only if the limits are all set): To reverse shade direction, press the **P1** Button for 10 seconds

Hold **P1** button



Motor Response

APPROX.



JOG  
X 3

## 4.3 Set Limits

Move the shade into the desired highest location.

Hold **UP** button  
until the shade is  
in desired position



Press **STOP**  
button



Hold **UP &  
STOP** button



Motor Response

APPROX. Motor  
Stops



Motor Response

APPROX. JOG  
X2



JOG  
X2

Move the shade into the desired lowest location.

Hold **DOWN** button  
until the shade is  
in desired position



Press **STOP**  
button



Hold **DOWN  
& STOP** button



Motor Response

APPROX. Motor  
Stops



Motor Response

APPROX. JOG  
X2



JOG  
X2



### IMPORTANT

The reversal of button directions option is unavailable while setting the Limits.

The motor will automatically go to **Continuous Travel** once the Limits are set.

# 5 ADJUSTING SET LIMITS

## 5.1 Adjust Upper Limit

Hold UP & STOP for 6 seconds to enter Adjustment Mode.

Hold **UP** &  
**STOP** button



Motor Response

APPROX.



Move the shade into the desired highest location.

Press **UP** or **DOWN**  
buttons to move  
shade

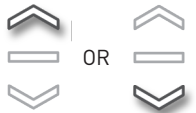

Hold **STOP** &  
**UP** button



Motor Response

APPROX.



### IMPORTANT

The Upper Limit can **NOT** be changed if it is currently sitting at the maximum height possible. Lower shade before beginning to change the upper Limit.



### IMPORTANT

After entering the Limit Adjustment Mode, any Favorite Positions that have been saved are deleted and need to be re-programmed.

If 4 minutes pass with no button press, the motor will exit the Limit Adjustment Mode and no new positions are set.



## 5.2 Adjust Lower Limit

Hold UP & STOP for 6 seconds to enter Adjustment Mode.

Hold  
**STOP & DOWN**  
button



Motor Response

APPROX.



Move the shade into the desired lowest location.

Press **UP** or **DOWN**  
buttons to move  
shade

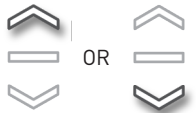

Hold **STOP &**  
**DOWN** button



Motor Response

APPROX.



### IMPORTANT

The Lower Limit can **NOT** be changed if it is currently sitting at the lowest height possible. Raise shade before beginning to change the upper Limit.



### IMPORTANT

After entering the limit adjustment mode, any favorite positions that have been saved are deleted and need to be re-programmed.

If 4 minutes pass with no button press, the motor will exit the limit adjustment mode and no new positions are set.

## 6 FAVORITE POSITION

### 6.1 Setting a Favorite Position

Move the shade into the desired position.

Press **UP** or **DOWN**  
buttons to move  
shade

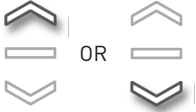

Hold **STOP**  
button



Hold **STOP**  
button



Motor Response when Favorite Position is set

APPROX.



Motor Response when Favorite Position is removed

APPROX.



#### IMPORTANT

Setting of Favorite position must  
happen within 16 seconds after  
first pressing the **STOP** button



#### IMPORTANT

The Favorite Position can NOT be set at the Upper or Lower Limit.

Adjustment of the Upper or Lower Limit will delete the Favorite Position from the Motor and needs to be reset.

### 6.2 Send Shade to Favorite Position

Hold **STOP**  
button



Motor Response

APPROX.



# 7 STEPPING MODE

## 7.1 Enter Stepping Mode

Hold **P1** button



Motor Response

APPROX.



Hold **STOP** Button



Motor Response

APPROX.



Hold **STOP** Button



Motor Response

APPROX.



### IMPORTANT

In stepping mode, Press **UP** or **DOWN** for 2 seconds to step or Long Press for continuous Travel.



**QUICK PRESS** = Stepping Mode



**LONG PRESS** = Continuous Travel Mode

## 7.2 Exit Stepping Mode

Hold **P1** button



Motor Response

APPROX.



Hold **STOP** Button



Motor Response

APPROX.



Hold **STOP** Button



Motor Response

APPROX.



## 8 ADJUSTING SPEED

### 8.1 Increase Motor Speed

Default motor mode is the slowest speed.

Hold **P1** button



Motor Response

APPROX.



Press **STOP** Button



Motor Response

APPROX.



Press **UP** Button



Motor Response

APPROX.



### 8.2 Decrease Motor Speed

Hold **P1** button



Motor Response

APPROX.



Press **STOP** Button



Motor Response

APPROX.



Press **DOWN** Button



Motor Response

APPROX.



## 9 RESTORE FACTORY SETTINGS

Hold P1 for 16 seconds to restore Factory Settings.

Hold **P1** button



Motor Response

APPROX.



## 9 TROUBLE SHOOTING

Problem	Cause	Remedy
The wand LED flashes when the motor is working.	The battery voltage is low.	Recharge battery with compatible AC adapter.
The motor is not responding.	Battery in motor is depleted.	Recharge battery with compatible AC adapter.
	Power Failure.	Check power connector is attached correctly to motor head.
	Incorrect Wiring.	Check power connector is attached correctly to motor head.

ROLLEASE ACMEDA | USA

750 East Main Street | 7th Floor  
Stamford, CT 06902, USA

T +1 800 552 5100 | F +1 203 964 0513

ROLLEASE ACMEDA | AUSTRALIA

110 Northcorp Boulevard,  
Broadmeadows VIC 3047, AUS

T +61 3 9355 0100 | F +61 3 9355 0110

ROLLEASE ACMEDA | EUROPE

Via Conca Del Naviglio 18,  
Milan (Lombardia) Italy

T +39 02 8982 7317 | F +39 02 8982 7317